

Pressure leaf filters are a proven cake filtration technology that are installed in thousands of installations worldwide. While the filter vessels operate for decades, the filter leaves need to be replaced a few times during the lifetime of the vessel.

The quality and condition of your filter leaves are critical to the productivity and performance of your pressure leaf filter system. Replacing worn or damaged filter leaves will result in an immediate improvement in system performance.

Envirogen offers high-quality filter leaves for almost every make or model of pressure leaf filter available on the market. Our Envi Leaf filters have a re-enforced box profile as standard with a five-layer mesh configuration and the very latest in high-flow nozzle technology.

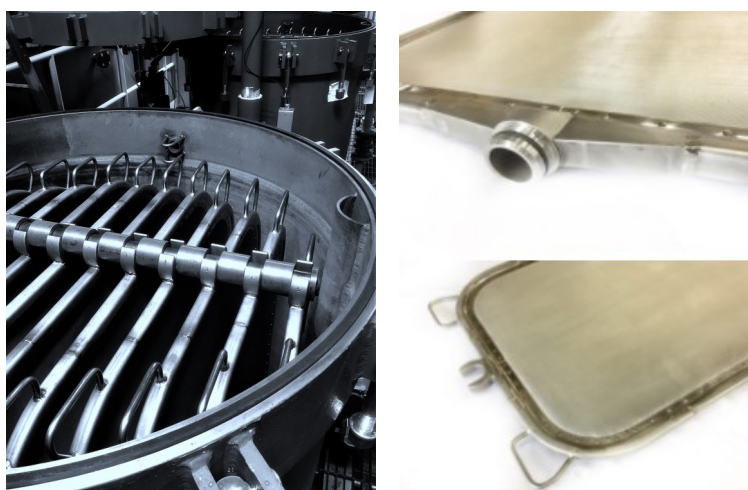

Features & Benefits

- **Longevity** – with five layers (ply) of stainless-steel wire mesh, each internal filter leaf is robust and designed for long-life
- **Reduced maintenance** – delivering a low total cost of ownership
- **Years of service** – long replacement periods mean that each leaf offers years of service
- **High-efficiency** – with excellent pre-coating properties
- **Flexibility** – The type of Envi Leaf filter leaves used can be swapped to accommodate multiple steps in the filtration process

Applications

- Edible oil processing (crude oil, bleached oil, winterized oil)
- Gelatin processing
- Pectin processing
- Glucose, sweeteners, sugar, fruit juice production
- Bio-diesel production (pre-treatment and polishing)
- Liquid sulfur filtration
- Chemicals and oleochemicals
- Organic and inorganic salts, amines, resins and bulk drugs

Technical Specifications

Our high-quality Envi Leaf filter leaves and filter plates come highly recommended and are available in a variety of materials, with a range of structures to suit every filtration task. Our team of experts are available to advise you of the optimum filter mesh depending on your application.

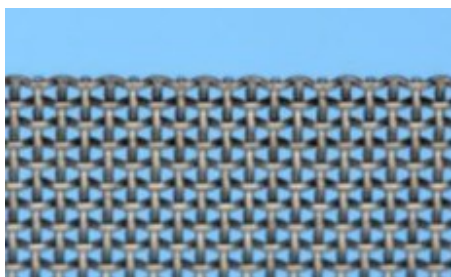

60 Mesh

- Plain weave filter screen
- Wire diameter: 0.19mm, 240µm
- Available materials: 316L, 317L, 904L stainless steel

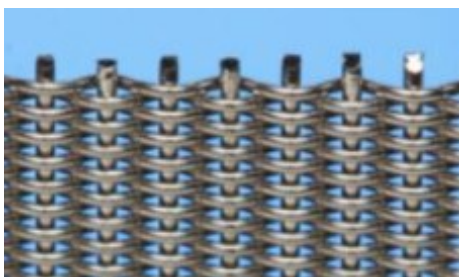

24 x 110 Dutch weave

- Plain weave filter screen
- Wire shute diameter warp: 0.35mm, 0.25mm, 125µm
- Available materials: 316L, 317L, 904L stainless steel

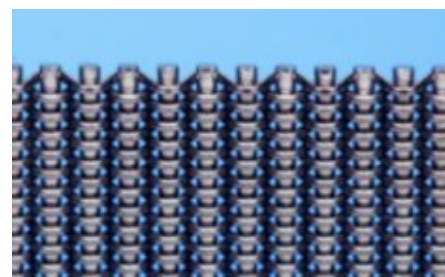

PZ80 (reversed plain Dutch weave)

- Dutch weave filter screen
- Wire shute diameter warp: 0.35mm, 0.25mm, 90µm
- Available materials: 316L, 317L, 904L stainless steel

Ordering Guide

For all inquiries it is essential to provide the following information:

- Filter manufacturer and model (see nameplate on vessel)
- Height of the filter leaf– Dimension “H”
- Width and number of filter leaves– Dimension “A”
- Top mesh and/or application
- Nozzle diameter– dimension “D”

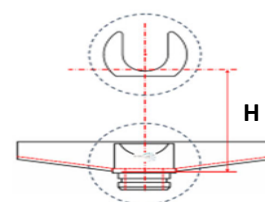
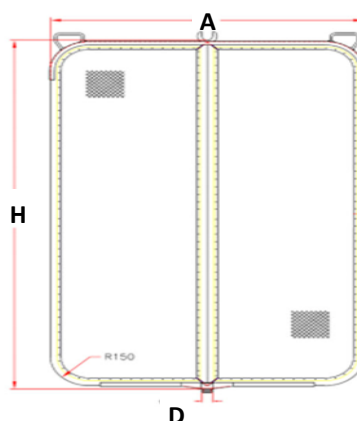

Envirogen Technologies reserves the right to incorporate our latest design and material changes without notice or obligation. Design features, materials of construction and dimensional data as described in this bulletin, are provided for your information only and should not be relied upon unless confirmed in writing.

Data contained in this bulletin are informative and subject to change without notice. User is responsible for determining whether the product fits for a particular purpose and is suitable for user's applications.

North American Headquarters

Envirogen Technologies Inc

2627 Chestnut Ridge Rd.,

Suite 260

Kingwood, TX 77339

T: 877.312.8950

E: info@envirogen.com

www.envirogen.com